

FLN Flood Light Datasheet

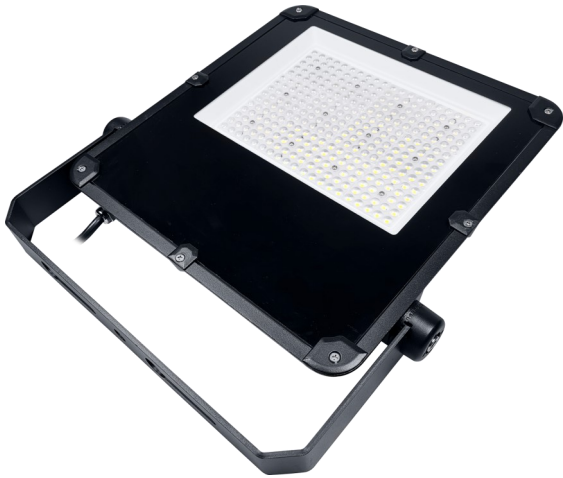

Key Features

Efficacy: Up to 150 lm/w

LED Chip: LUMILEDS

SDCM: <5

Beam Angle: 30°/60°/90°/Type II/Type III PC lens

IP Rating: IP65

Installation: Bracket

Warranty: 5 years

Application

Shopping malls, exhibition halls, car parks, stadiums, stadiums, billboards, parks, sculpture, building facades and other indoor and outdoor lighting.

Photometry

30° PC lens

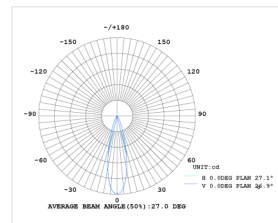

60° PC lens

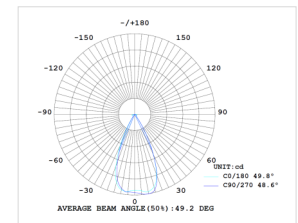

90° PC lens

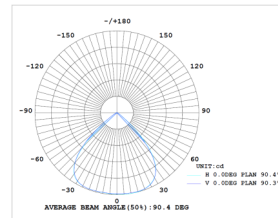

Type II PC lens

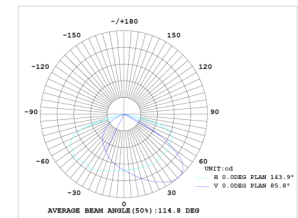

Type III PC lens

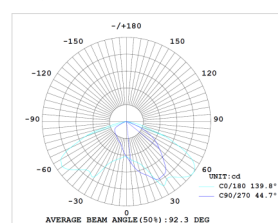

FLN Flood Light Datasheet

Product Data

Model No.	KML-FL050N	KML-FL080N	KML-FL100N	KML-FL150N	KML-FL200N	KML-FL240N	KML-FL300N
Wattage	50W	80W	100W	150W	200W	240W	300W
Lumen Output	7,500 lm	12,000 lm	15,000 lm	22,500 lm	30,000 lm	36,000 lm	45,000 lm
Luminous Efficacy	150 lm/w						
CCT	3000K/4000K/5000K/5700K/6500K						
CRI	Ra≥70 (Ra≥80 optional)						
Input Voltage	100-277 VAC/220-240 VAC; 50Hz/60Hz						
Housing Color	Black						
Housing Material	Aluminum, Glass, PC						
Operating temperature	-30°C to +55°C						
Operating humidity	10% to 90% RH						
Lifespan	100,000 hours						
Warranty	5 years						

ErP Technical Specification

Item	Specification/Data
Efficiency In	>93%
Power Factor	PF>0.90
Energy Efficiency Class	D
Standard Deviation of Color Matching	<5
Starting Time	<0.2S
Warm-up Time to 60%	<0.5S
Lumen Maintenance at e.o.l.	>70%
Lifetime	L70/B10@100,000hours

Note: 1. The above parameters will have errors within the allowable range of relevant standards.

2. This specification book is for reference only. We retains the right to optimize and modify without pre -notification!



www.kmlled.com

Add: #116, Xiangshan Rd, Songgang, Bao'an, Shenzhen, China. Tel: +86-755-29868817

FLN Flood Light Datasheet

Ordering Information

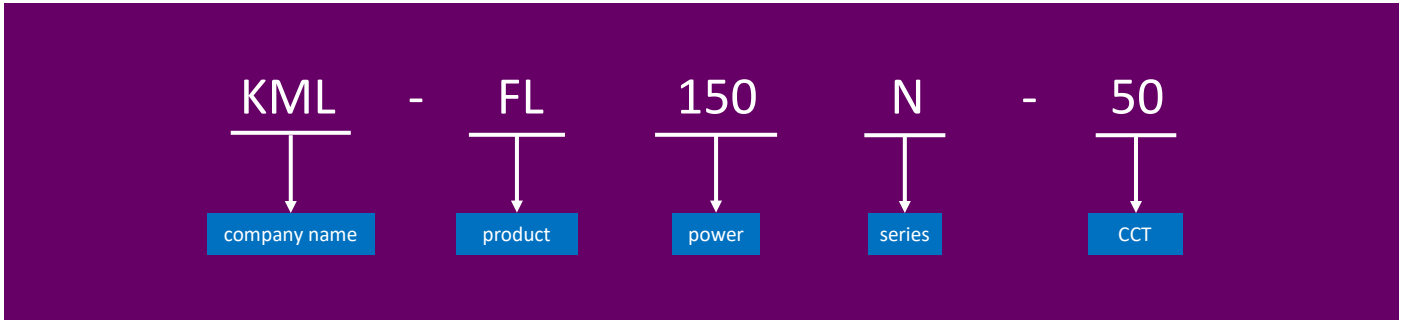

Mounting & Accessories

	UGR Reflector
	<i>Black Steel</i>

Packaging (UGR reflector not included)

SKU	PCS/CTN	N.W	G.W	Volumetric Weight	CBM	20' GP	40' GP
KML-FL050N	10	1.2 kg/pcs	15.5 kg/ctn	11.6 kg	L482xW336xH358 mm \approx 0.058 m ³	482 CTNs	1,172 CTNs
KML-FL080N	10	1.4 kg/pcs	17.5 kg/ctn	11.6 kg	L482xW336xH358 mm \approx 0.058 m ³	482 CTNs	1,172 CTNs
KML-FL100N	1	3.4 kg	4.0 kg	2.5 kg	L385xW355xH90 mm \approx 0.012 m ³	2,333 CTNs	5,666 CTNs
KML-FL150N	1	4.1 kg	4.8 kg	3.0 kg	L425xW390xH90 mm \approx 0.015 m ³	1,866 CTNs	4,533 CTNs
KML-FL200N	1	5.0 kg	5.8 kg	3.2 kg	L420xW415xH90 mm \approx 0.016 m ³	1,750 CTNs	4,250 CTNs
KML-FL240N	1	5.2 kg	6.0 kg	3.2 kg	L420xW415xH90 mm \approx 0.016 m ³	1,750 CTNs	4,250 CTNs
KML-FL300N	1	6.0 kg	7.3 kg	4.6 kg	L505xW460xH100 mm \approx 0.023 m ³	1,217 CTNs	2,956 CTNs

Remarks: The weight of the above products is for reference only, and the weight of different configuration products will be different.



www.kmlled.com

Add: #116, Xiangshan Rd, Songgang, Bao'an, Shenzhen, China. Tel: +86-755-29868817

FLN Flood Light Datasheet

Dimension (unit: mm)

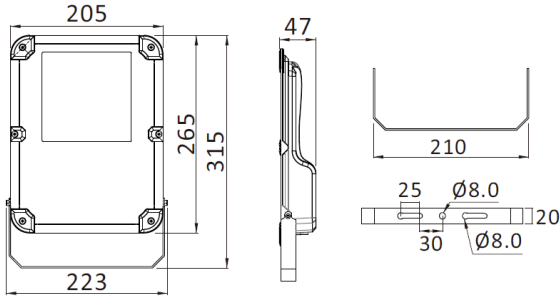

KML-FL050N/KML-FL080N

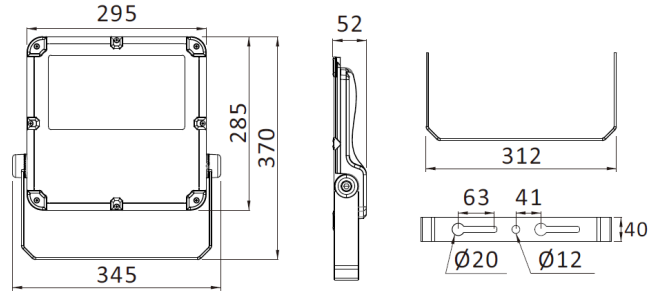

KML-FL100N

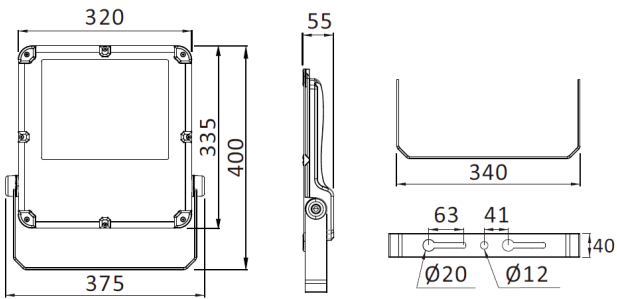

KML-FL150N

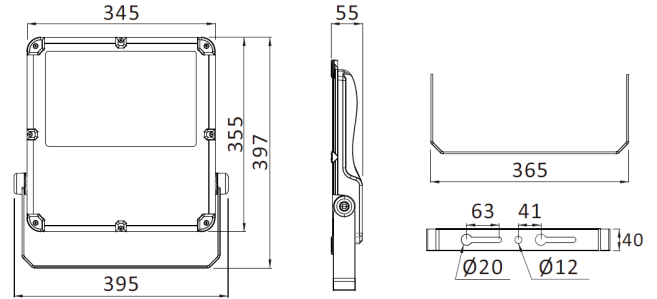

KML-FL200N/KML-FL240N

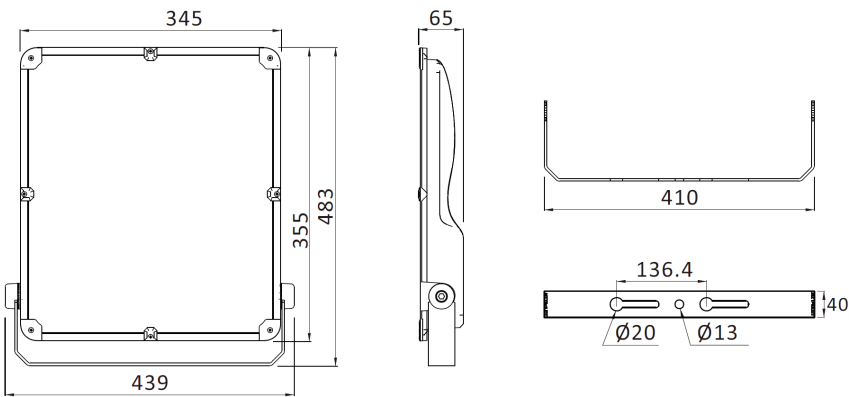

KML-FL300N